

Fingerprint Pad

Clear & crisp imprint

I.D. Technologies



CERAMIC PAD SURFACE
With Print Capacity of
1200 imprint

Ceramic pad surface utilizing a dark ink approved for use by law enforcement.

Gives a dark, very clear, crisp imprint, leaving very little ink residue on fingers.



Ink dries instantly and does not smear.

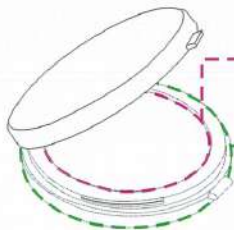

Print area size: Ø45mm

Overall size: Ø57mm

LE2R Print area size: Ø45mm RM 30

Auto numbering machine

Manual automatic switchboard



Quality metal construction for constant use and long life.



Drop alpher features allows you to print only the numbers required



convenient plunger lock allows easy setting of number wheels



INK COLOUR
■ BLACK



5mm 1 2 3 4 5 6

20600 Movements. 7 RM 158



4mm 1 2 3 4 5 6 7 8

20800 Movements. 7 RM 219



4mm 1 2 3 4 5 6 7 8 9 0

21000 Movements. 3 RM 315



TO ORDER GO TO LAST PAGE

The rubber type printing system

RIBtype®



The RIBtype rubber type system allows you to easily change printed information on cartons, packages and products.

Each piece of rubber type has ribs on the back so it can be pressed into the ribbed rubber base on your marking equipment.

This type is used on coders, marking machines, hand printers and stamps that have the rubber rib-base with them.



Type Set

CONTENTS OF **A SET** (158 Pcs)

7 LETTERS EACH	A E N
5 LETTERS EACH	BCDFGHIJKLM
3 LETTERS EACH	QXY
2 LETTERS EACH	0-9
1 LETTERS EACH	./

CONTENTS OF **C SET** (89 Pcs)

9 LETTERS EACH	0 - 9
3 LETTERS EACH	,
2 LETTERS EACH	./

SPECIFICATION

Size of RIB-Type	Code	A set (RM)	C set (RM)	Individual (RM)
3mm	RT3	154	119	3
4mm	RT4	160	121	3
5mm	RT5	160	123	4
6mm	RT6	212	158	4
8mm	RT8	230	163	5
10mm	RT10	291	171	7
13mm	RT13	391	246	10
17mm	RT17	656	357	15
20mm	RT20	983	444	18

Special Size

Ribbed Base

1 st cm² RM 5

Additional cm² RM 2/cm²



Custom stamps are made to-order

Self-inking stamp

JustRite

Justrite stamps are for customers looking for printers. Date of manufacture. Printer Expiration Date And the text on the goods or packaging, which is the least investment. It is easy to use or suitable for SME business.



Ribbed Base acid-resistant and solvent-resistant rubber



Ink Pad Water-based ink liner made of wooden fabric, resistant to solvent and ink.

Preview with Self-Inking Stamp by Justrite



Putting a rubber letter into a Justrite stamp.



J31 Plate Size: 22 X35mm RM 170



J52 Plate Size: 39 X66mm RM 355

Specially for fast drying ink & Rubber-Type

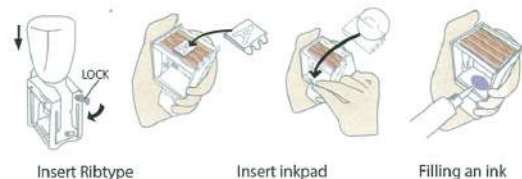

Insert Ribtype

Insert inkpad

Filling an ink

RECEIVED BY
收件人

FROM

CONTACT PERSON (MR/MRS/MS)

TEL NO. FAX NO.

MOBILE NO. DATE (DD/MM/YY)



TEXT ARRANGEMENT 文字安排 COLOR 颜色 TOTAL QTY 总数量 AESSB USE

→

 +
 蓝 BLUE
 黑 BLACK
 红 RED
 紫 PURPLE
 绿 GREEN
 粉红 PINK

DATE _____
RCVD.: _____

CODE 编号 _____ X
QTY 数量 _____

STAMP

CODE 编号 _____ X
QTY 数量 _____

COLOP
MARKING SOLUTIONS

CODE 编号 _____ X
QTY 数量 _____

Flash
SYSTEM

CODE 编号 _____ X
QTY 数量 _____

ISTAMP

CODE 编号 _____ X
QTY 数量 _____

INDEX
STAMP

CODE 编号 _____ X
QTY 数量 _____

COLOP
P700

CODE 编号 _____ X
QTY 数量 _____

Name Tag

CODE 编号 _____ X
QTY 数量 _____

Student STAMP
Teacher STAMP

CODE 编号 _____ X
QTY 数量 _____

SEAL

CODE 编号 _____ X
QTY 数量 _____

Wax Seal

CODE 编号 _____ X
QTY 数量 _____

Button Badge

CODE 编号 _____ X
QTY 数量 _____

Name Card

CODE 编号 _____ X
QTY 数量 _____

Sticker

ROUND STAMP

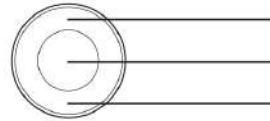

Dia : Ø _____ mm

OVAL STAMP

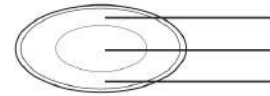

Size: _____ X _____ mm

FAUZUL ENTERPRISE